

1

2

A

A

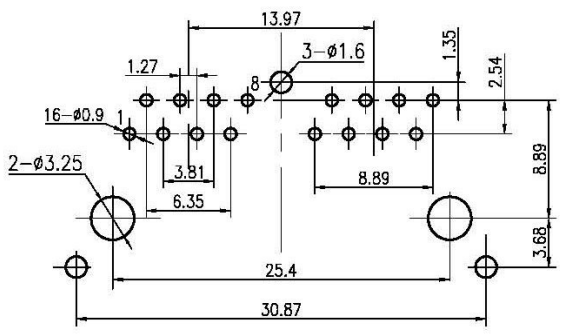

SPECIFICATIONS

CURRENT RATING: 1.5A
 VOLTAGE RATING: 125V AC
 INSULATION RESISTANCE: 500M Ω Mini
 WITHSTAND VOLTAGE: AC 1500 V RMS 50Hz OR 60Hz 1 Min
 CONTACT RESISTANCE: 20m Ω Max
 INSERTION FORCE: 2 CONTACTS-----350g 4 CONTACTS-----500g
 6 CONTACTS-----750g 8 CONTACTS-----900g
 10 CONTACTS-----1050g
 RETENTION STRENGTH: 7.7Kg BETWEEN JACK AND PLUG
 DURABILITY: 750 MATING CYCLES Mini
 HOUSING: 1) GLASS FILLED PA66 (UL 94V-0)
 2) GLASS FILLED PA46 (UL 94V-0)
 3) GLASS FILLED PBT (UL 94V-0)
 SPRING WIRE: 1) 0.45mm DIA PHOSPHOR BRONZE GOLD PLATING OVER NICKEL
 2) 0.35mm THICKNESS PHOSPHOR BRONZE ALLOY SELECTIVE GOLD PLATING OVER NICKEL
 SHIELDING: 0.25mm THICKNESS COPPER ALLOY WITH TIN PLATED
 GOLD PLATING: 3 μ *, 6 μ *, 15 μ *, 30 μ *, 50 μ *
 WORKING TEMPERATURE: -40 $^{\circ}$ C ∞ 70 $^{\circ}$ C

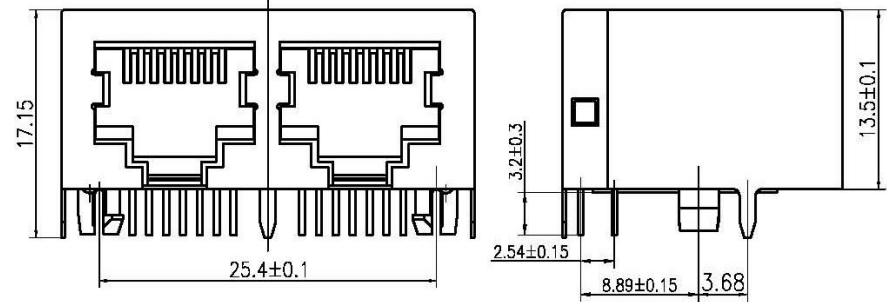
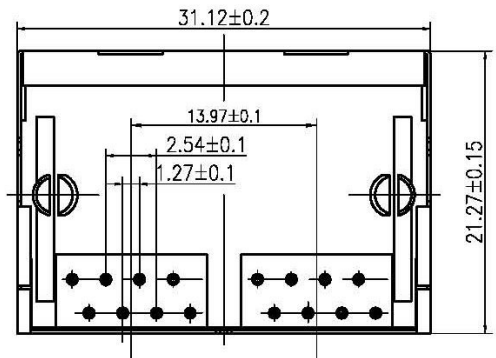

B

B

CPTC 喆揚科技有限公司
Compass Power Technology Ltd.

Designed
Checked
Approved

MATERIAL

DESCRIPTION

W-B012-F12

Mark DATE

FIRST ANGLE PROJECTION

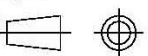

CUSTOMER MODEL NO.

SCALE

2:1

UNIT

mm

DWG NO.

B03011001211

REV.

V1.0

1

2